

**FIRST FLOOR PLAN**  
SCALE 1:100

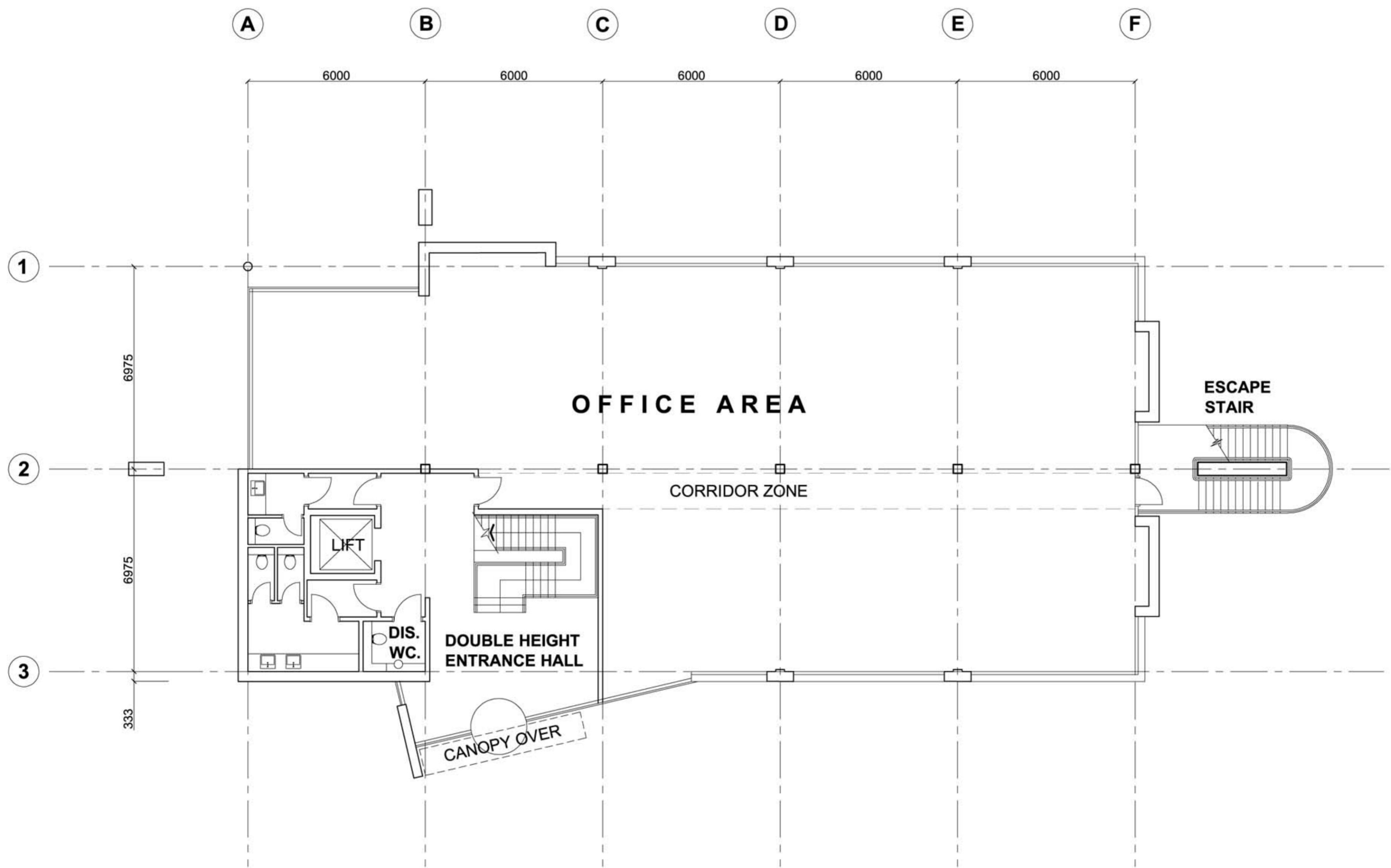

**GROUND FLOOR PLAN**  
SCALE 1:100

**FLOOR AREAS**  
*(note the areas have been calculated by computer and do not allow for building tolerances)*

Gross Floor Area - approx **422 sq.m (4542 sq.ft)**

Nett Floor Area - approx **334 sq.m (3595 sq.ft)**  
*(note nett area excludes stairs, core and plant areas)*

**PHASE 2D, CAPITOL PARK, LEEDS.**

PROPOSED PLANS  
SCALE 1:100

Project  
**PHASE 2D, CAPITOL PARK  
LEEDS**  
for Sterling Capitol Park Leeds

Title  
**Ground & First Floor Plans**

Scale  
**1:100**

Date  
**February 2006**

Drawn by  
**RHA**

Drawing Number  
**0508 / P4**

Revision

**GARNETT  
NETHERWOOD  
ARCHITECTS**

Design Innovation Centre  
46 The Cattle  
Leeds LS2 7EY

Telephone 0113 244 8858  
Fax 0113 244 8125  
E Mail mail@gnaarchitects.co.uk